

Assemblaggio sistema scorrimento "MIRROR" – Assembly sliding system "MIRROR" – Montage système guidage "MIRROR"

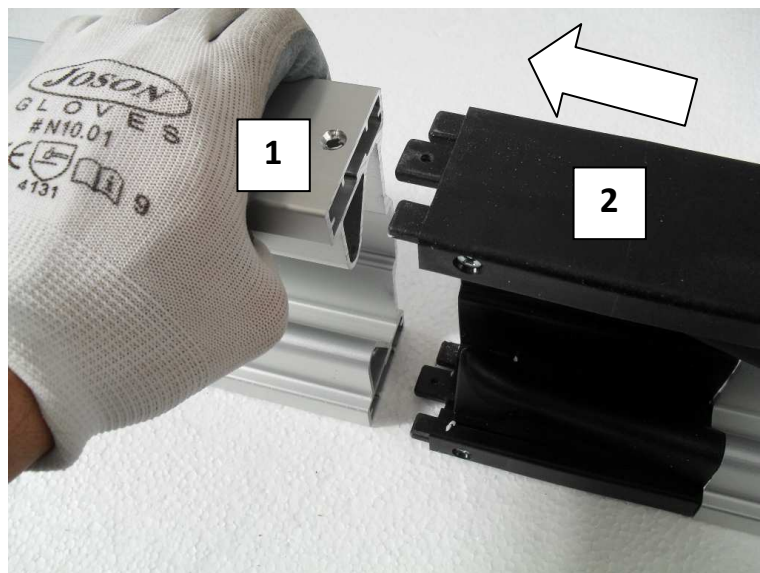

1) Togliere viti da binario apertura.
Remove screws from opening track.
Enlever les vis sur le rail d'ouverture.

2) Inserire binario chiusura (v.fotografia).
Insert closure track (see photo).
Insérer le rail de fermeture (voir photo) .

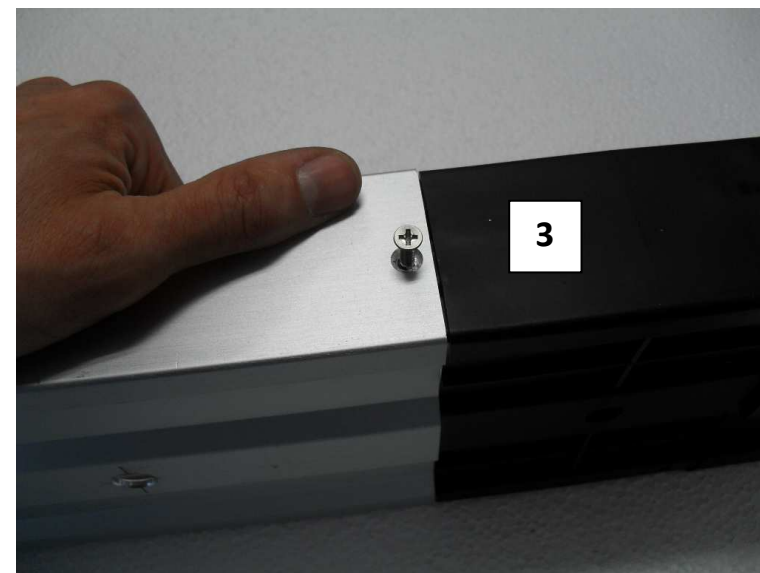

3) Fissare i binari con le viti precedentemente tolte.
Fixing the tracks with the screws removed previously.
Fixer les rails avec les vis enlevées précédemment.

OPTIONAL Solo per porte provviste di copertina – Only for door with cover track – Seulement pour porte avec cache rail

1) Togliere la copertina prima di installare il binario.
Remove the cover before installing the track.
Enlever le cache rail avant l'installation du rail.

2) Assemblare ed installare il binario.
Assembly and install the track.
Assembler et installer le rail .

3) Rimontare la copertina dove precedentemente montata.
Reassemble the cover where previously mounted.
Remonter le cache rail où déjà monté.

SCHEMA DI MONTAGGIO PORTE SCORREVOLI
SCHEMA MONTAGE PORTES COULISSANTS
SLIDING DOORS HOOKUP DIAGRAM

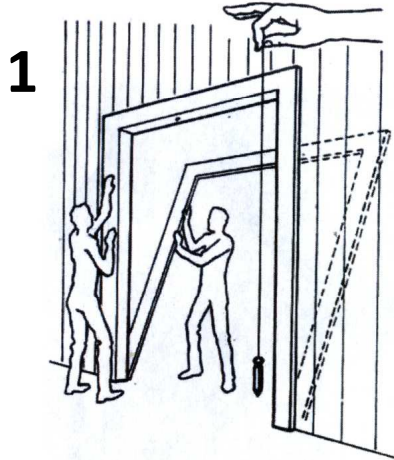

APPLICARE IL TELAIO DELLA PORTA PERFETTAMENTE VERTICALE SULLA PARETE E BLOCCARE AVVITANDO LA "CPR".
APPLIQUER LE BATI DE LA PORTE PARFAITEMENT VERTICALE SUR LA PAREI ET BLOQUER EN VISSANT LA "CPR".
MOUNT THE DOOR FRAME ON THE WALL IN A PERFECTLY VERTICAL POSITION AND FIX FIRMLY, TIGHTENING THE "CPR".

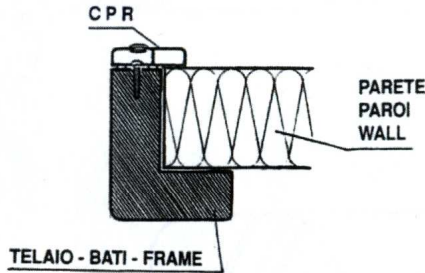

Posizione binario - Track position - Position du rail

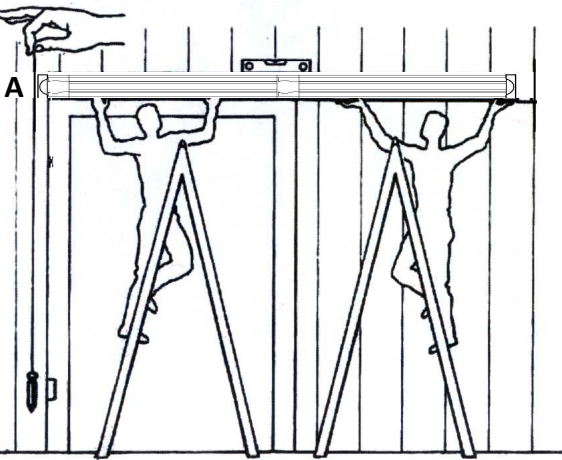
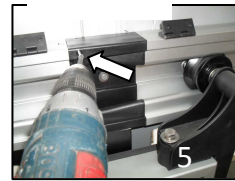
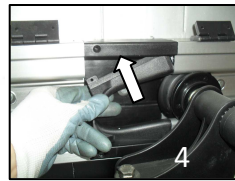
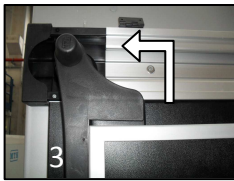
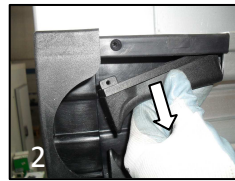
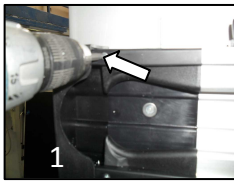
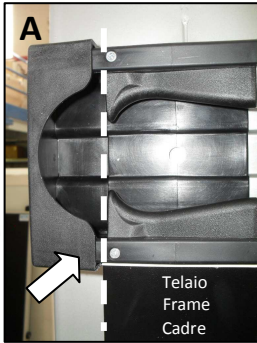

APPLICARE SUL TELAIO E CONTRO LA PARETE IL TRAVERSONE CON IL BINARIO PERFETTAMENTE ORIZZONTALE.
APPLIQUER SUR LE BATI ET CONTRE LA PAREI LA TRAVERSE AVEC LE RAIL PARFAITEMENT HORIZONTAL.
APPLY THE RAIL ON THE FRAME AND AGAINST THE WALL WITH THE RUNNER IN A PERFECTLY HORIZONTAL POSITION.

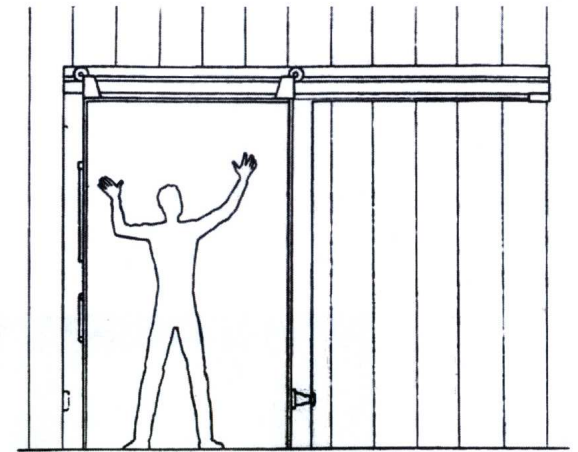
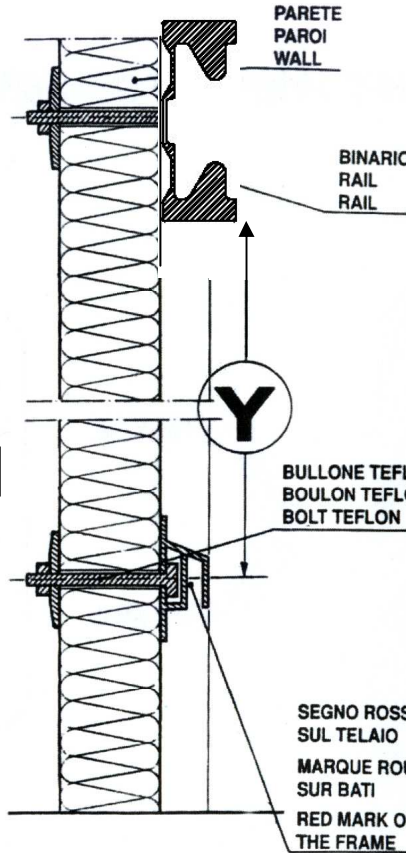

AGGANCIARE IL BATTENTE SCORREVOLE SUL BINARIO DEL TRAVERSONE.
ACCROCHER LE BATTANT COULISSANT SUR LE RAIL DE LA TRAVERSE.
HOOK THE SLIDING WING ON THE RUNNER RAIL.

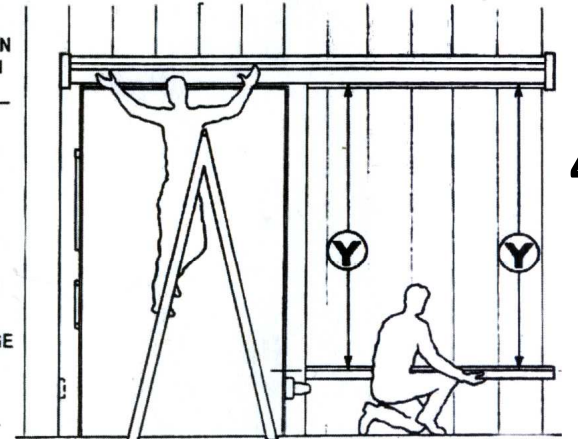

APPLICARE LA GUIDA POSTERIORE IN ALLUMINIO USANDO BULLONI, DADI, RONDELLONI IN TEFLON BIANCO. PER FARE I FORI DEI BULLONI IN TEFLON BISOGNA OSSERVARE SCRUPolosAMENTE LA QUOTA "Y". APPLI-

APPLIQUER LE COULISSEAU POSTERIEUR EN ALUMINUM EN UTILISANT BOULONS, ECROUS ET RONDELLES EN TEFLON BLANC. POUR FAIRE LES TROUS DES BOULONS EN TEFLON. IL EST NECESSAIRE D'OBSERVER TRES ATTENTIVEMENT LA MESURE "Y". APPLI-

APPLY THE REAR GUIDE IN ALUMINIUM USING BOLTS, NUTS AND LARGE WASHERS IN WITHE TEFLON. WHEN MAKING HOLES IN THE TEFLON BOLIS IT IS ESSENTIAL TO SCRUPulously RESPECT THE "Y" DIMENSION. APPLI-